

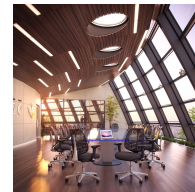

NEED ASSISTANCE OR CUSTOM QUOTE? CALL: 888-507-6631 www.njmodern.com

reverb premium office chair

\$734.00



Description

reverb is a flexible and responsive chair built for years of ergonomic comfort. designed to offer support over both your lower and upper back regions, the flexible nylon back and waterfall seat design help keep you alert, while effectively distributing the weight of your body. the pneumatic lever and tension control knob fine-tune the chairs height and tilt to personalize reverb, while the pivot and height adjustable armrests make sure your upper-body is well-positioned. although nylon designs have increased in popularity in recent years, reverb offers a choice that is both stylish and works admirably well to protect your body from daily stresses. the aluminum base comes equipped with five dual-wheeled hooded casters for easy gliding over carpeted surfaces, and the molded foam seat pan comes generously

padded for extra comfort. set includes: one - reverb office chair

Additional Information

SKU	SMODC11259
Dimensions	Overall Product Dimensions: 25.5"L x 26.5"W x 38.5 - 42.5"H Seat Dimensions: 18.5"L x 21"W x 19 - 23"H Base Dimensions: 21"L x 21"W Armrest Height: 27 - 34"H Backrest Height: 19.5"H